

SENSE 55 SOCHI 2014 3 cabins - 3 head compartments - 1 Occasional cabin (optional)

EC CERTIFICATE Category A - 10 persons

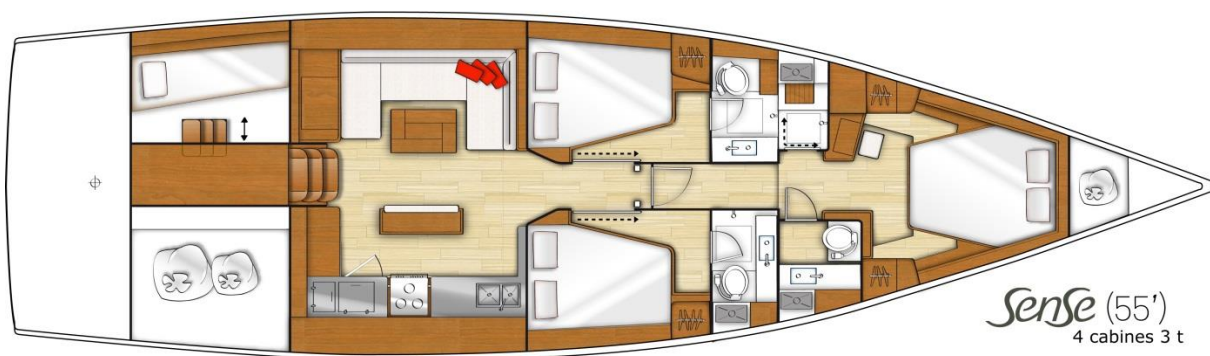

| | |
|--|-----------------------------|
| L.O.A | 17,20 m 56'5" |
| Hull length | 16,80 m 55'1" |
| L.W.L. | 15,93 m 52'3" |
| Beam | 4,97 m 16'4" |
| Deep draught (min) | 2,35 m 7'9" |
| Deep ballast weight | 4 900 kg 10,800 lbs |
| Shallow draught (min) | 1,80 m 5'11" |
| Shallow ballast weight | 5 500 kg 12,122 lbs |
| Air draught (max) | 23,91 m 78'5" |
| Light displacement (EC) | 18 560 kg 40,906 lbs |
| Fuel capacity (standard) | 415 110 US Gal |
| Freshwater capacity (standard) | 640 169 US Gal |
| Freshwater capacity (Optional equipment) | 330 87 US Gal |
| Engine power | POD 120 |
| Mainsail (classic) | 74 m ² 796 sq ft |
| Genoa | SELF-TACKING JIB HARDWARE |



Prices per week in €:

| | | | |
|-------------------------|---------------|--------------|---------------|
| Beneteau Sense55 | 01.01.-26.04 | 26.04.28.06 | 28.06.-30.08. |
| | 18.10.-31.12. | 30.08-18.10 | |
| | 6 840 | 9 000 | 10 800 |

Inventory list

MOTOR VERSION - YANMAR 4JH4TCE POD 120 DIESEL DOCK + GO (Autopilot and Bow thruster)

TRIM LEVEL - INSPIRATION 2014

Electronic: 1 Multifunction touchscreen e95 LCD (GPS - Chart plotter - Chart reader - Without chart - Cartography Europe included) Starboard steering console
Electronic: 1 i70 Raymarine screen (Loch, Speedometer, Depth sounder) - To port steering console
Electronic: - Multifunction touchscreen e125 LCD - Chart table
Cockpit sole natural solid wood
Galley: 12 V Freezer compartment in 100 L Top-opening icebox
2 service batteries (2 x 140 Amperes x 12 V) + 40 amperes Additional battery charger
LED: Outside and inside lighting (except deck light)
Indirect LED lighting under high cupboards
Shore freshwater supply
Galley: Freshwater purifier
1 Port electric coachroof winch H50.2 STECH
Inner forestay chainplate
Multimedia system: Radio CD/DVD PIONEER - Speakers BOSE ACOUSTIMASS® 3 - Outside loudspeakers SONY
Motorised glazed folding companionway door in cockpit floor - 2 Remote controls
Textile storage with 2 steering consoles

PACK ELECTRONIC 2014

To port steering console: 1 Multifunction touchscreen e95 LCD (GPS - Chart plotter - Chart reader - Without chart - Cartography Europe included)
Starboard steering console: 1 i70 screen (Windvane - Anemometer)
Wifi interface

2 FLAG HALYARDS

ELECTRIC GENOA SHEET WINCHES H60.2STCE/60.STC

ELECTRIC STARBOARD COACHROOF WINCH H46.2STCEH/46.2STC

GRAPHITE COACHROOF SPRAYHOOD

GRAPHITE COCKPIT BIMINI

NATTE STONE & QUADRI GREY OUTSIDE UPHOLSTERY

ADDITIONAL WATER TANK (330 LITERS)

GENERATOR 7 KVA 220V 50HZ - WITH COCOON

MICROWAVE OVEN 220V

ICE MAKER 220V 50HZ

CHILLED WATER AIR CONDITIONING 30000 BTU 220V 50HZ

ELECTRIC TOILET QUIET FLUSH CENTRAL PORTSIDE

ELECTRIC TOILET QUIET FLUSH STARBOARD FORWARD + HOLDING TANK

ELECTRIC TOILET QUIET FLUSH CENTRAL STARBOARD+ HOLDING TANK

EXTRA FUEL TANK (415 LITERS)

3 FOLDING BLADES PROPELLER (DOCK & GO)

32"TV + DVD-MP3-CD PLAYER IN SALOON

RADAR HIGH DEFINITION (RADOME ONLY)

WINDEX WINDVANE